

BLUED

CALIBER
.44 Magnum

RUGER®

MODEL 44 CARBINE

Autoloading Carbine



PLEASE CONTACT NEW HAMPSHIRE CUSTOMER SERVICE FOR AVAILABILITY OF 44 CARBINE PARTS. Contact the Customer Service Department at our facility in New Hampshire concerning servicing. Your request should be sent to: Sturm, Ruger & Co., Inc., 411 Sunapee Street, Newport, New Hampshire 03773, 603-863-3300. We cannot comply with open account or C.O.D. orders. Payment in the form of a check, money order, Visa or MasterCard. When using your credit card include the account number, expiration date and whether it is a Visa or MasterCard account. Include the entire serial number of the firearm when contacting the Service Department. The price shown for parts does not include the minimum net labor charge of \$15.00 plus \$5.00 shipping and handling if parts are factory fitted. All factory fitted parts are fitted on an exchange basis only. We will not return the replaced parts. The charge for metal refinishing is \$35.00 plus a \$5.00 shipping and handling charge. Custom gunsmithing service or nonstandard alterations are **NOT AVAILABLE**.

Because it is a serial numbered component, the Carbine Barrel-Receiver Assembly is defined as a “firearm” by Federal Law and is not sold as a separate component. The Barrel-Receiver of the Model .44 Carbine is an integrated assembly, therefore, the barrel alone is not available as a separate component part.

BARREL NOTE: All barrels are marked with safety message. (“Before using gun, read warnings in Instruction Manual available free from Sturm, Ruger & Co., Inc., Southport, CT, USA.”)

Design, specifications and prices are subject to change without notice. The Sturm, Ruger & Company “LOGO”, “RUGER”, “10/22” and “77/22” are registered U.S. trademark



WARNING—PARTS PURCHASERS



It is the purchaser’s responsibility to be absolutely certain that any parts ordered from the factory are correctly fitted and installed. Firearms are complicated mechanisms and **IMPROPER FITTING OF PARTS MAY RESULT IN A DANGEROUS MALFUNCTIONING, DAMAGE TO THE FIREARM AND INJURY TO THE SHOOTER AND OTHER PERSONS**. The purchaser and installer of parts must accept full responsibility for the correct adjustment and functioning of the firearm after such installation.

PARTS MUST FIT CORRECTLY

STURM, RUGER & Company, Inc.
Southport, Connecticut 06490 U.S.A.

MODEL 44 CARBINE

COMPONENT PARTS

44 CARBINE PARTS ARE NO LONGER AVAILABLE
PRICES ARE LISTED FOR HISTORICAL REFERENCE ONLY

Part Name	Part No.	Model	Caliber .44 Mag.	Price
* Barrel-Receiver Assembly, Specify Model & Serial Number	C-100	44 R, YR25	• No Longer Available	
Barrel Band, Carbine Stock	C-68	44 R, RS, SP, YR25	•	\$ 6.75
Barrel Band Screw	C-69	44 R, RS, SP, YR25	•	.50
* Bolt, Only, Specify Model & Serial Number	C-10	44 R, RS, SP, YR25	•	22.50
* Bolt, Assembly, May Not Fit All Models, Specify Model & Serial Number	NC-10AC	44 R, RS, SP, YR25	•	27.75
Butt Plate	C-63	44 R, RS, SP, YR25	•	2.50
Butt Plate Screw	C-64	44 R, RS, SP, YR25	•	.50
*† Cartridge Guide Plate, Not Illustrated	C-6	44 R, RS, SP, YR25	•	4.75
Cartridge Stop	C-40	44 R, RS, SP, YR25	•	1.00
Cartridge Stop Flat Spring	C-41	44 R, RS, SP, YR25	•	.50
Cartridge Stop Flat Spring Retaining Pin	C-42	44 R, RS, SP, YR25	•	.50
Cartridge Stop Coil Spring	C-43	44 R, RS, SP, YR25	•	.50
Cartridge Stop Pivot Pin	C-44	44 R, RS, SP, YR25	•	.50
Disconnecter	C-25	44 R, RS, SP, YR25	•	2.00
Disconnecter Plunger	C-26	44 R, RS, SP, YR25	•	.50
Disconnecter Plunger Spring	C-27	44 R, RS, SP, YR25	•	.50
Disconnecter Plunger Spring Screw	C-81	44 R, RS, SP, YR25	•	.50
* Ejector	C-8	44 R, RS, SP, YR25	•	.50
Ejector Screw	C-9	44 R, RS, SP, YR25	•	.50
Extractor	C-14	44 R, RS, SP, YR25	•	.50
Extractor Spring	C-15	44 R, RS, SP, YR25	•	.50
Extractor Pivot Pin	C-16	44 R, RS, SP, YR25	•	.50
Firing Pin	C-11	44 R, RS, SP, YR25	•	2.25
Firing Pin Retaining Pin	C-13	44 R, RS, SP, YR25	•	.50
Firing Pin Retaining Spring	C-12	44 R, RS, SP, YR25	•	.50
Flapper	C-45	44 R, RS, SP, YR25	•	1.50
Flapper Spring	C-46	44 R, RS, SP, YR25	•	.50
Front Sight	C-75	44 R, RS, SP, YR25	•	3.00
Hammer, Including Rammer	C-17	44 R, RS, SP, YR25	•	6.50
Hammer Pivot Pin	C-19	44 R, RS, SP, YR25	•	.50
Hammer Spring Retaining Pin	C-37-D	44 R, RS, SP, YR25	•	.50
Hammer Springs, Right & Left	C-18	44 R, RS, SP, YR25	•	.50
Lifter Assembly	C-34	44 R, RS, SP, YR25	•	12.50
Lifter Cam	C-55	44 R, RS, SP, YR25	•	.75
Lifter Cam Pin	C-57	44 R, RS, SP, YR25	•	.50
Lifter Cam Spring	C-56	44 R, RS, SP, YR25	•	.50
Lifter Dog	C-30	44 R, RS, SP, YR25	•	6.50
Lifter Dog Pivot Pin	C-31	44 R, RS, SP, YR25	•	.50

*Parts designated by an asterisk must be factory fitted. These parts are fitted on an exchange basis only. We will not return the replaced parts. We will not return any part that is broken, malfunctioning, badly worn or has been modified. See "Warning — Parts Purchasers" back cover.

†Cost of factory installation is \$24.75.

MODEL 44 CARBINE

COMPONENT PARTS

44 CARBINE PARTS ARE NO LONGER AVAILABLE
PRICES ARE LISTED FOR HISTORICAL REFERENCE ONLY

Part Name	Part No.	Model	Caliber .44 Mag.	Price
Lifter Latch	C-35	44 R, RS, SP, YR25	•	\$ 4.75
Lifter Latch Pivot Pin	C-37	44 R, RS, SP, YR25	•	.50
Lifter Latch Plunger	C-39	44 R, RS, SP, YR25	•	.50
Lifter Latch Spring	C-38	44 R, RS, SP, YR25	•	.50
Magazine, Complete, 5-Shot Capacity Specify Model & Serial Number	C-103	44 R, RS, SP, YR25	•	10.50
Medallion, Pistol Grip	C-107M	44 R, RS, SP, YR25	•	.50
Piston Specify Model & Caliber	C-58	44 R, RS, SP, YR25	•	2.75
Piston Block Plug Retaining Pin, 2 Req'd.	C-61A & B	44 R, RS, SP, YR25	•	.50
Piston Blocking Plug Specify Model & Caliber	C-60	44 R, RS, SP, YR25	•	1.50
Piston Plug Set Screw, Adjustable Slide, Not 1/16	C-89	44 R, RS, SP, YR25	•	.50
Rear Sight	C-76	44 R, SP, YR25	•	7.75
Rear Sight, Receiver, Williams	C-76R	44 RS	•	No Longer Available
Receiver Cross Pin	C-5	44 R, RS, SP, YR25	•	.50
Receiver Filler Screws, 4 Req'd.	C-83	44 R, RS, SP, YR25	•	ea. .50
Recoil Block	C-65	44 R, RS, SP, YR25	•	6.25
Recoil Block Bolt	C-66	44 R, RS, SP, YR25	•	1.00
Recoil Block Bolt Washer	C-67	44 R, RS, SP, YR25	•	.50
Safety	C-52	44 R, RS, SP, YR25	•	1.50
Safety Detent Plunger	C-53	44 R, RS, SP, YR25	•	.50
Safety Detent Plunger Spring	C-54	44 R, RS, SP, YR25	•	.50
Sear	C-23	44 R, RS, SP, YR25	•	3.50
Sear Spring	C-24	44 R, RS, SP, YR25	•	.50
* Slide Assembly	C-47	44 R, RS, SP, YR25	•	57.25
Slide Handle	C-48-B	44 R, RS, SP, YR25	•	No Longer Available
Slide Spring	C-50	44 R, RS, SP, YR25	•	1.50
Sling Swivel Base	B-92	44 SP	•	2.25
Sling Swivel Base Screws, 2 Req'd.	B-93	44 SP	•	ea. .50
Sling Swivel, Front, Not Illustrated	C-77	44 R, RS, YR25	•	No Longer Available
Sling Swivel, Rear, Not Illustrated	KMS07600	44 R, RS, SP, YR25	•	5.50
Stock, Assembly, Complete, Carbine Only	C-102R	44 R, RS, YR25	•	140.00
Trigger/Sear Assembly (Includes Disconnecter, Trigger Pivot, Cross Pin & Trigger Spring)	C-20SA	44 R, RS, SP, YR25	•	4.25
Trigger Guard, Assembly, Complete Specify Model & Serial Number	NC-101	44 R, RS, SP, YR25	•	No Longer Available
*†† Trigger Guard, Only Specify Model & Caliber	NC-2	44 R, RS, SP, YR25	•	38.25
Trigger Pivot Pin	C-21	44 R, RS, SP, YR25	•	.50

*Parts designated by an asterisk must be factory fitted. These parts are fitted on an exchange basis only. We will not return the replaced parts. We will not return any part that is broken, malfunctioning, badly worn or has been modified. See "Warning — Parts Purchasers" back cover.

††If installed at the factory your cost is \$67.25.

MODEL 44 CARBINE

Firearms users are cautioned that a gun containing modified, broken, malfunctioning, or badly worn parts should not be fired!

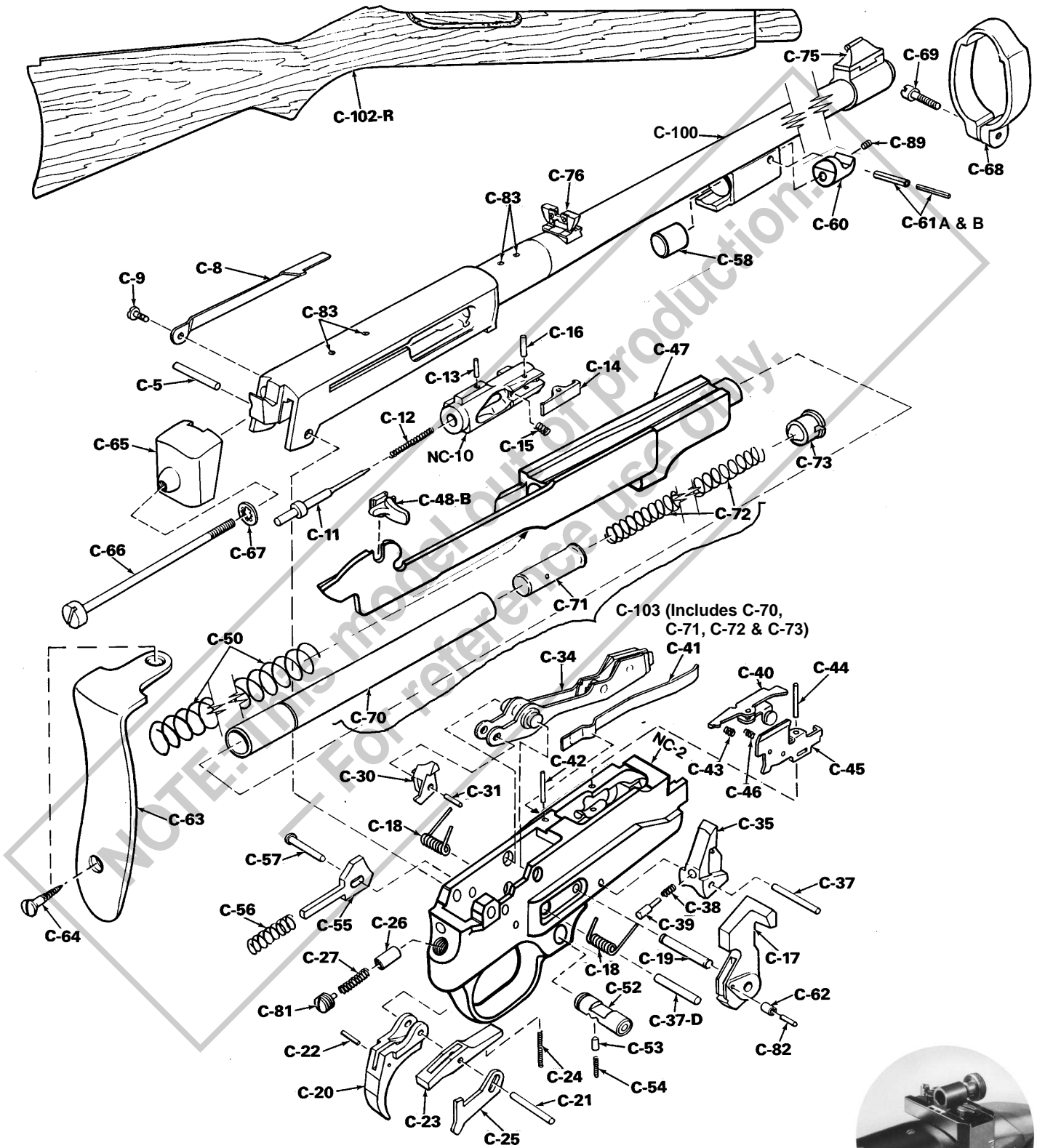

WILLIAMS RECEIVER
REAR SIGHT
C-76R

